

ROBLEY, HERVIN G. CHARLES--CH. CH. I.

265

BURIAL GROUND FORM
WORKS PROGRESS ADMINISTRATION
Indian-Pioneer History Project for Oklahoma

266

Field worker's name Marvin G. Rowley

This report made on (date) April 20 1937

and additional information April 27, 1937.

1. Name (if any) of burial ground _____

2. Founded (date) 1869 By _____

3. Abandoned (date) 1870 Why abandoned _____

4. Present owners of premises G. L. Woods

Address of present owners Poteau, Oklahoma

NOTE: Answer fully, if possible, questions 5 to 13 inclusive, here or on sheets firmly attached to this form.

- 5. Original owners of premises.
- 6. Give names of other persons who at one time owned the premises.
- 7. Approximate number of graves. 3
- 8. Approximate number of marked graves 2
- 9. General condition of headstones, including inscriptions.
- 10. Number of inscriptions copied and attached. Two (Place each inscription on a separate sheet and attach all to this form).
- 11. Any other information you were able to gather about the burial ground including its history.
- 12. Condition of the premises Cultivated field
- 13. Detailed location of burial ground.

14. Legal location of burial ground, County LeFlore

Section 24 Township 7N Range 25E

(north)

The plat on this form represents 640 acres, one square mile, and is subdivided into 40 acre tracts. The center of the section, and burial ground should be located accordingly. If possible, make additional subdivisions on plat to give more accurate location.

Number of sheets attached to this form Four

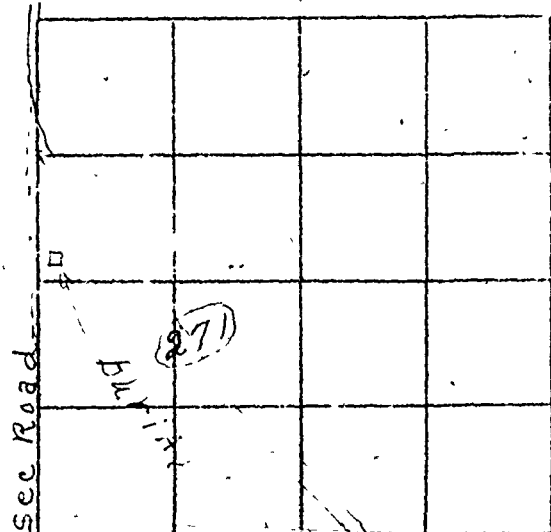

1

E ASHLY BURNS

WAS. BORN. JUNE

THE 18. 1825 AND

DIED. FEB THE 8, 1869

THE. HOLYBIBLE IS THE

BOOK. OF TRUTH.

OKRCHATONR

WAS BORN MAY THE

15 AD 1823 DIED JULY

THE 2 1870

DEPART INPEACE.

2

This burial ground contains three graves. It is located on Townsite Addition No. 2, Lot 16, Government Survey. This is in sec. 24, Township 7n, Range 25E, Poteau, Oklahoma.

This Burial ground is in a cultivated field, that is owned by C. L. Woods, Poteau Oklahoma. He has owned this land for about six years. The land is cultivated by Vassar Hoyle, who remembers playing on the enclosing wall 40 years ago.

The two following graves are in the enclosing wall; E. Ashly Burns, to the west, and Okrchatonr to the East.

The wall is about four feet high, ten feet on the sides, and about sixteen (16) inches thick. It has a dividing wall in the center running North and South. These walls are constructed to run North and South, East and West. They are made of flat and square sand-stone, set in a brown-grey mortar. Part of the wall is in good condition. The head stone of Okrchatonr, is placed in the side of the wall on a flat sand-stone slab. The plaque, that belongs to the grave of Burns, has fallen out onto the ground. These head-stones are in the South wall. On the side of the Burns graves is growing a water-oak tree, about ten inches in diameter. In the North-east corner of the Okchatonr side is another water-oak,

but it is dead. Where this tree is growing, the wall had fallen down to some extent. The Inscriptions have very poor workmanship, but are cut quite deep. (enclosing an exact copy of the Inscriptions)

Mrs. Montie Page gave me the following information pertaining to these graves. Mrs. E. Ashly Burns was a full-blood Choctaw, who lived about three hundred yards west of the present graveyard. "When I," Mrs. Montie Page, first knew her, she was a widow who lived in an old double log house that had an open hall-way through the center of it. She had no children that I knew of except an adopted daughter, named Salina Willis. Bob Page lived there also, he later married Salina. When Mrs. Burns died, she willed the stuff in the house to Salina and the land to Will and Bob Page. (See Marley French of Hughs or Fanshaw.)

Okrechatonr was a full-blood Choctaw Indian. I do not know any thing about him. He is buried in the East side of the burial enclosure.

Salina Willis is buried just outside of the west side of the wall. There used to be a head-stone but it is gone now. They are plowing over her grave now.

"Mrs. E. Ashly Burns died over at the foot of Cavenal Mountain. They brought her back to the old home place to be buried.

"Salina Willis was a full-blood Choctaw Indian.

"Mrs. E. Ashly Burns was a Tarby before her marriage. I, Montie Page, knew her in 1869, when I was a little girl."

BURIAL GROUND FORM
WORKS PROGRESS ADMINISTRATION
Indian-Pioneer History Project for Oklahoma

(271)

Field worker's name Marvin G. Rowley

This report made on (date) May 6 1937

1. Name (if any) of burial ground Illis Indian Burial Ground

2. Founded (date) _____ By Illis Indian

3. Abandoned (date) _____ why abandoned _____

4. Present owners of premises Bill Williams

Address of present owners 1022 N. 1st St. Okla.

NOTE: Answer fully, if possible, questions 5 to 13 inclusive, here or on sheets firmly attached to this form.

- 5. Original owners of premises.
- 6. Give names of other persons who at one time owned the premises.
- 7. Approximate number of graves. _____
- 8. Approximate number of marked graves seven
- 9. General condition of headstones, including inscriptions.
- 10. Number of inscriptions copied and attached. _____ (Place each inscription on a separate sheet and attach all to this form).
- 11. Any other information you were able to gather about the burial ground including its history.
- 12. Condition of the premises Bad
- 13. Detailed location of burial ground.

14. Legal location of burial ground, County LeFlore

Section 11.14 Township 7H Range 25E

The plat on this form represents 3600 acres, one square mile, and is subdivided into 360 acre tracts. The center of the section, and burial ground should be located accordingly. If possible, make additional subdivisions on plat to give more accurate location.

Number of sheets attached to this form 1

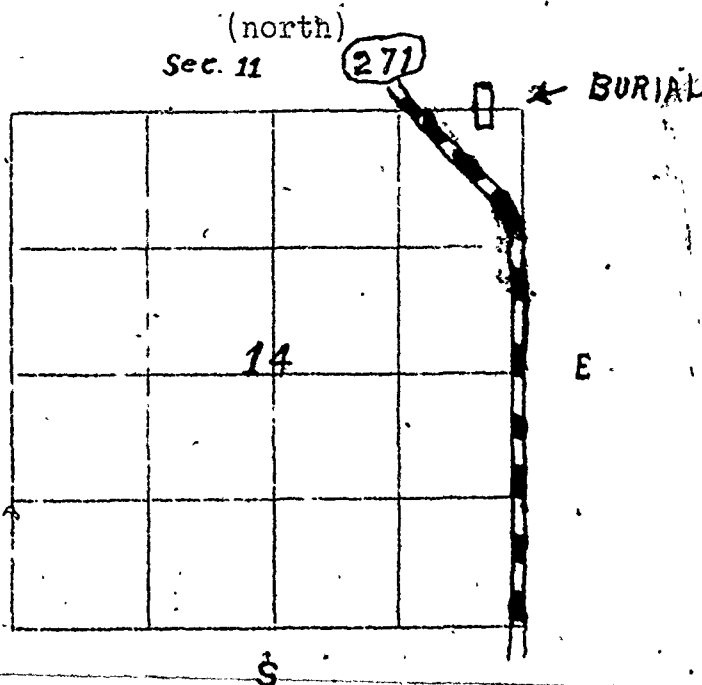

This Willis Indian Family Grave yard is on the section line of 11 and 14, twp. 7 N, and range 20 E.

It is badly grown up in vines, weeds and trees. This land is owned by Bell Williams. His wife was Ann Willis, a Choctaw Indian. It is her family that is buried here.

She owned it when she married Williams. Williams farms the surrounding land. By reports that I have received, this burial ground has been in use at least fifty years by the Willis family. There are two marked graves with inscriptions on them. They are as follows:

This one is marked with a white tombstone.

J. W. Willis,

Oct. 15, 1909. Died Oct. 15, 1918

This one is marked with a metal grave marker.

David Willis,

Died April 11, 1925.

There are five more graves that I could tell were there by the sandstone markers. These had no inscriptions on them. There is, without doubt, several more graves, but they are not marked.

I have noticed several large holes that looked as though someone had been digging in this grave yard for valuables which might have been buried with the bodies of some of the older Willis family. I was told that Les Willis was buried here, also, but I could not find out which grave. They still use this as a burial place for the Willis family. They are all Choctaw Indians.
